

See Inset A

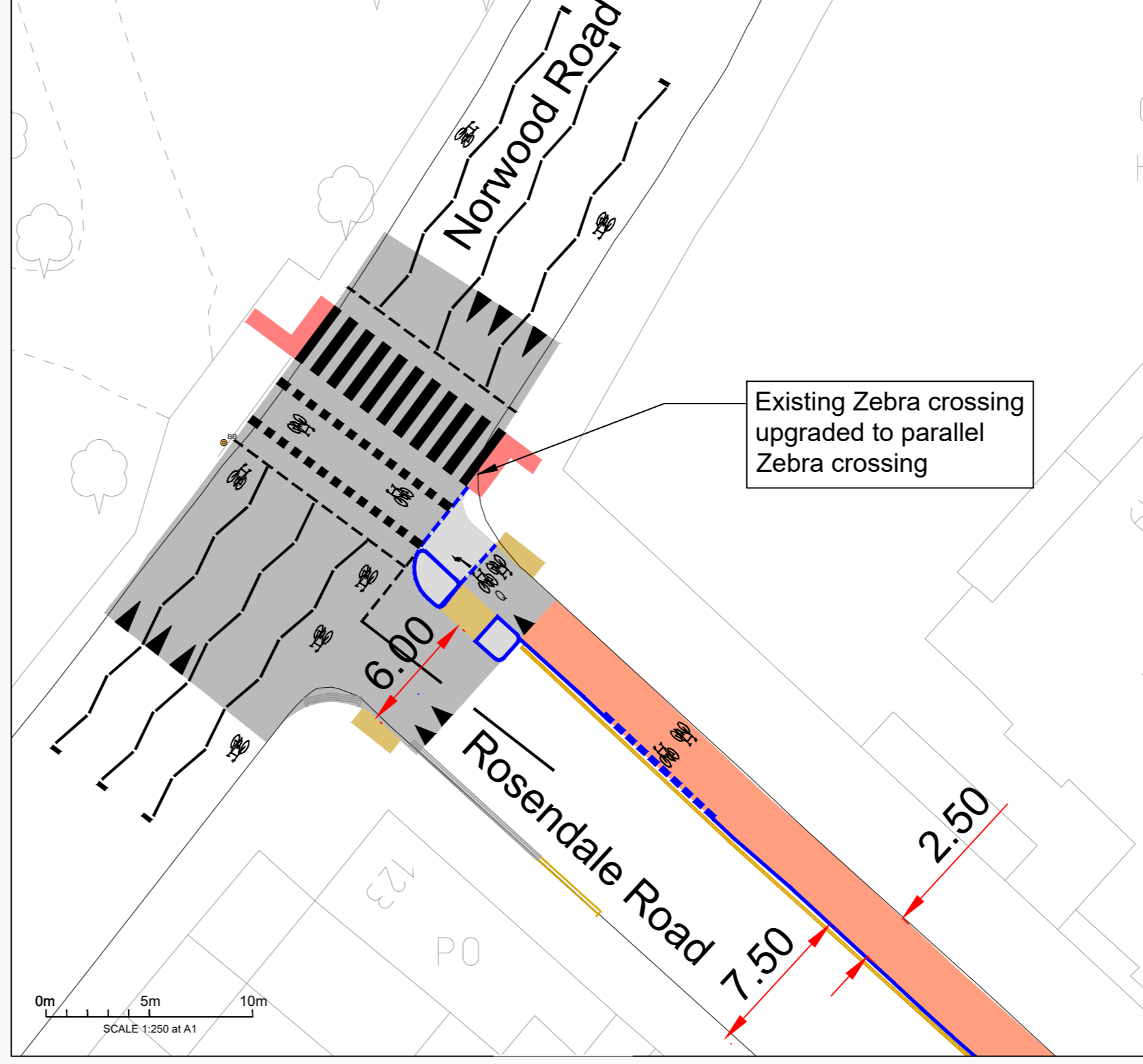

Inset A

See Inset B

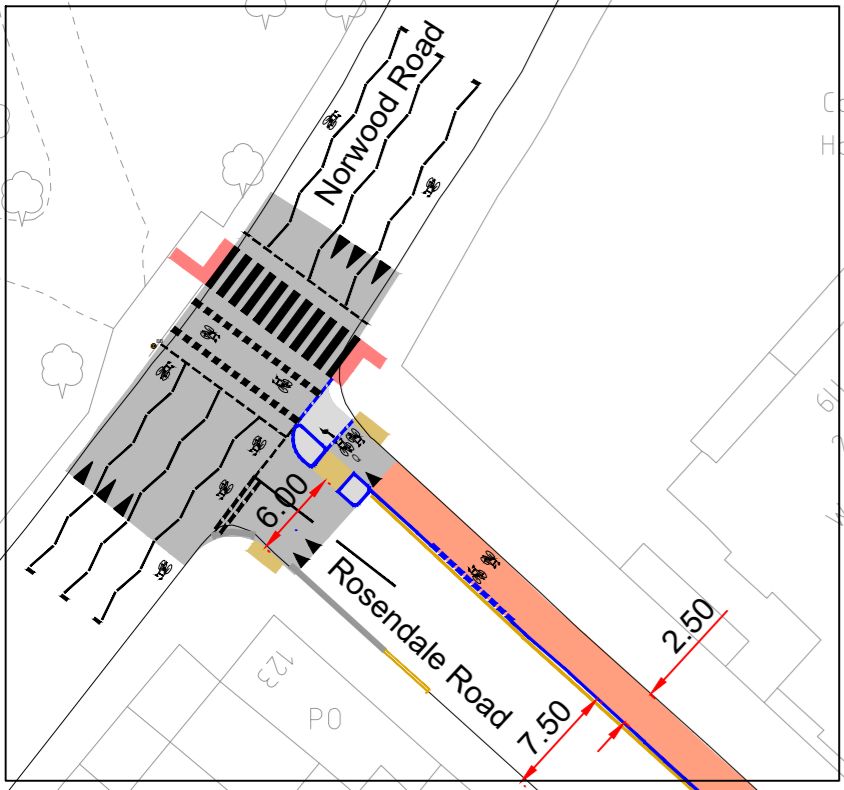
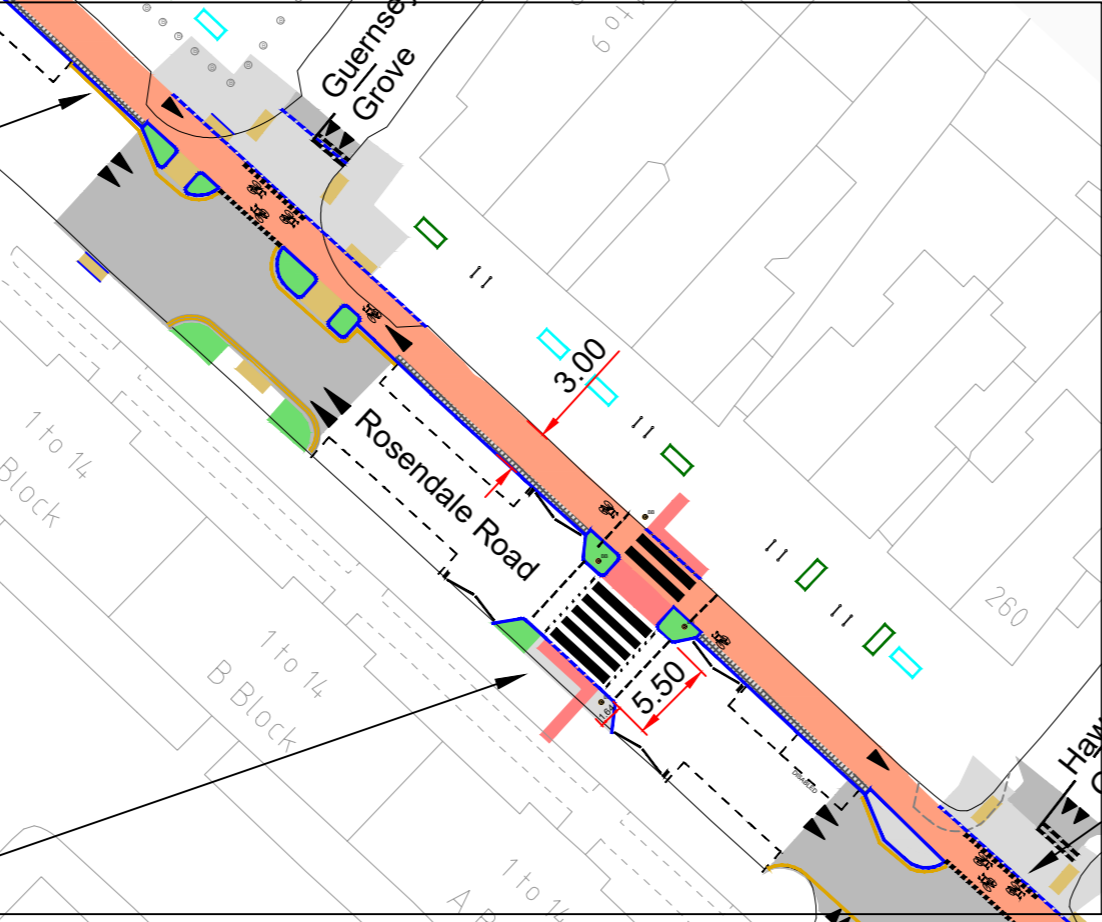

Inset B

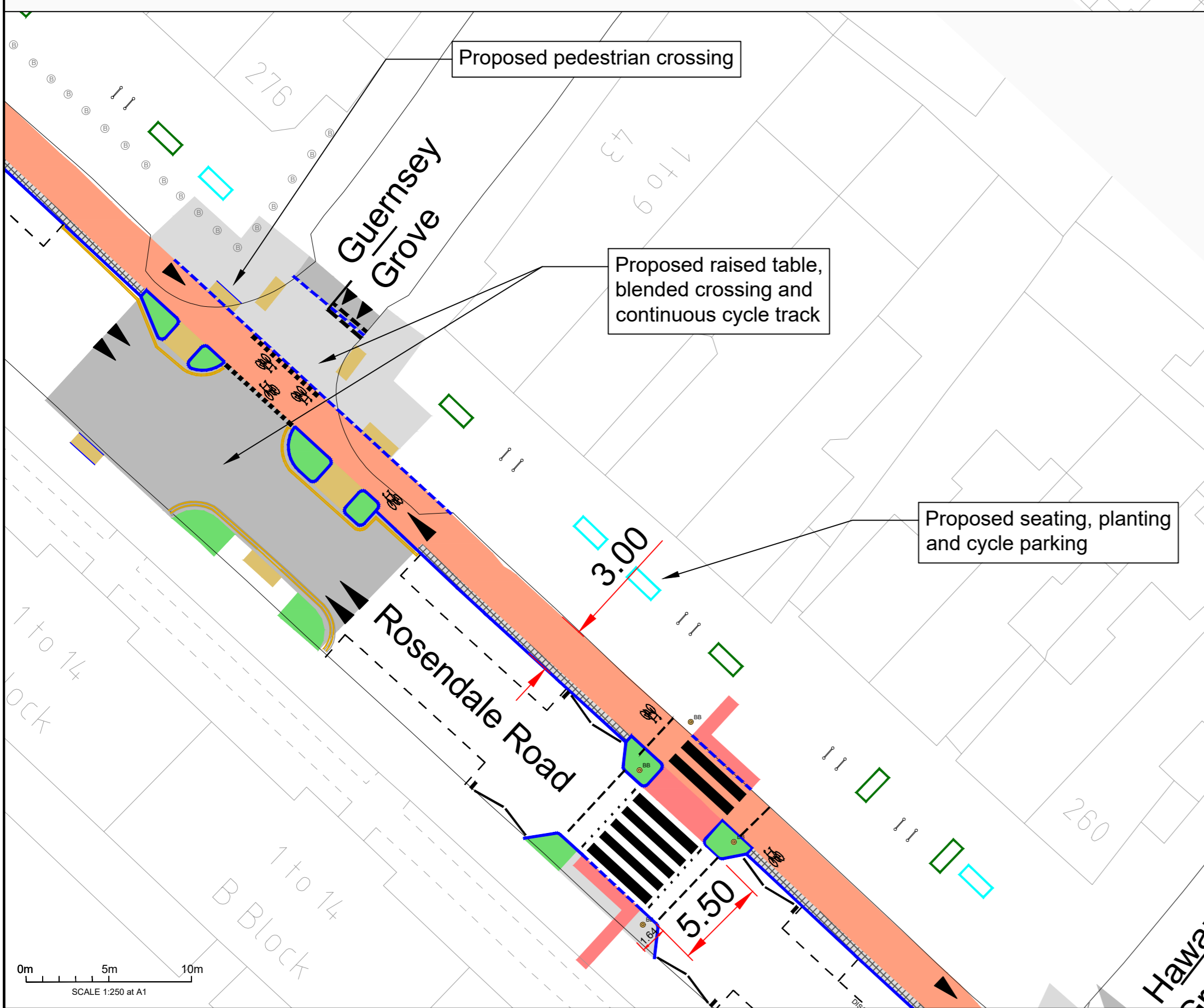

- Key:**
- Proposed greening / sustainable drainage.
 - Proposed footway paving.
 - Proposed raised table.
 - Proposed cycle track.
 - Proposed granite footway.
 - Proposed kerb.
 - Proposed dropped or flush kerb.
 - Proposed white line markings.
 - Proposed yellow line markings.
 - Proposed cycle parking stand.
 - Proposed controlled crossing tactile paving.
 - Proposed uncontrolled crossing tactile paving.
 - Proposed speed hump.
 - Existing line markings to be retained.
 - Proposed tree and tree pit, subject to ground surveys.
 - Proposed planter.
 - Proposed bench.
 - Proposed collapsible bollard.
 - Proposed collapsible bell bollard.



Project:
**Healthy Route:
Brockwell Park to Gipsy Hill**

Title:
**Proposed Layout
Sheet 1 of 5**

Date:
22/01/2020

Scale at A1:
As stated

Status:
Consultation

Drawing No:
Q7-RO-HL-GA-00-00-01

Revision:
-

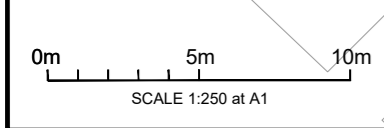

© Crown copyright and database rights 2019 Ordnance Survey 100032811 10158

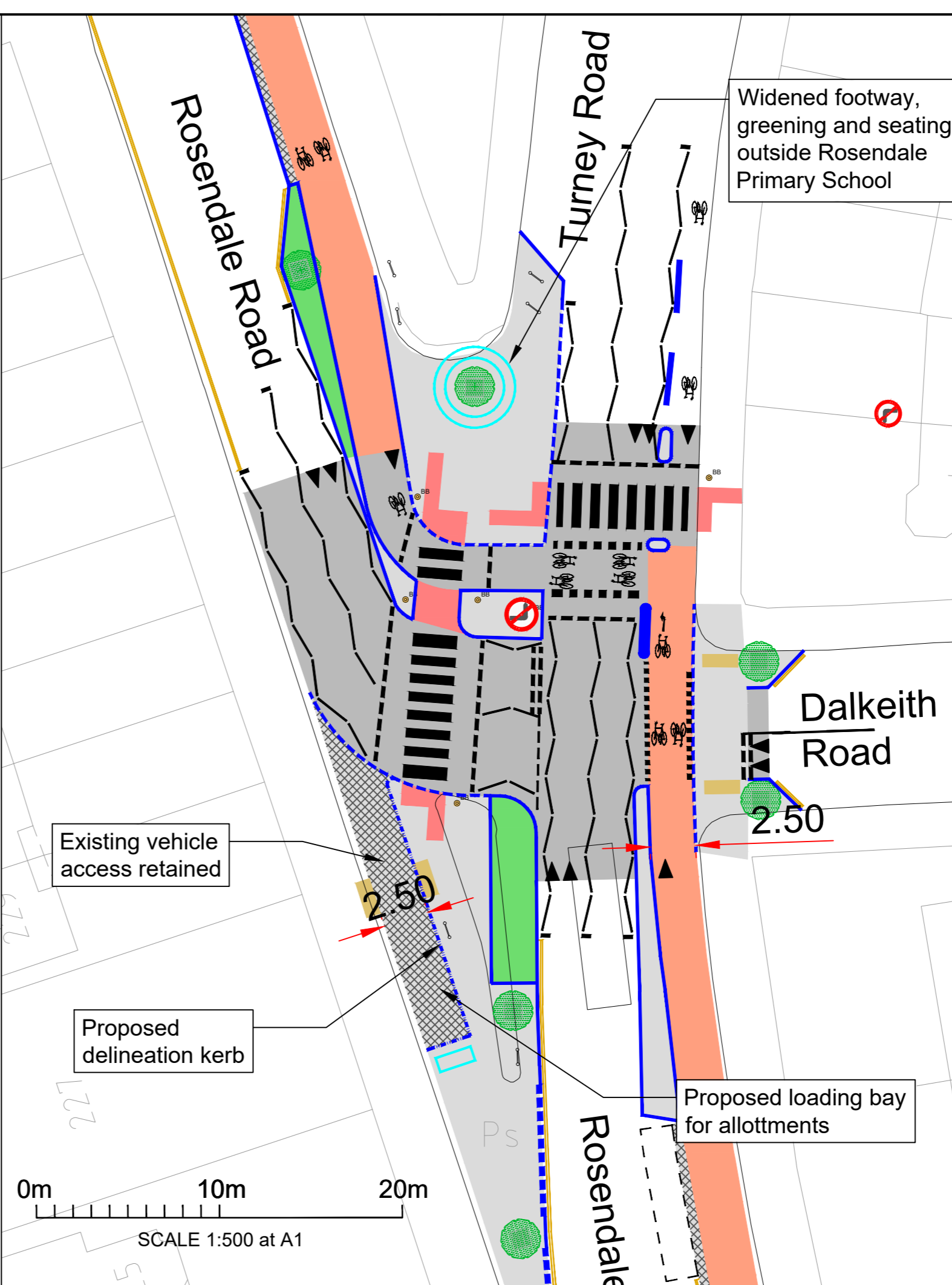
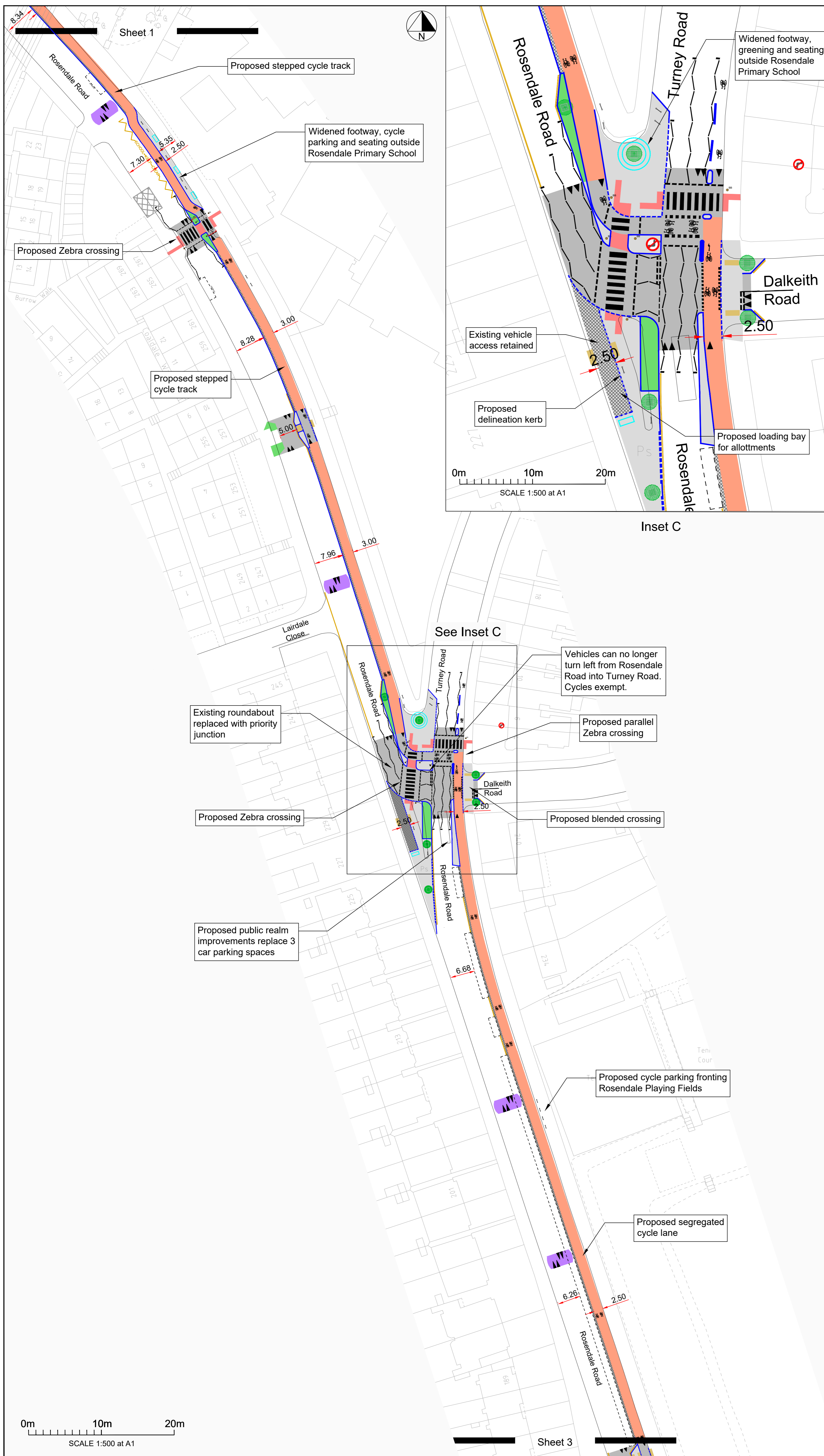

- Key:**
- Proposed greening / sustainable drainage.
 - Proposed footway paving.
 - Proposed raised table.
 - Proposed cycle track.
 - Proposed granite footway.
 - Proposed kerb.
 - Proposed dropped or flush kerb.
 - Proposed delineation kerb.
 - Proposed white line markings.
 - Proposed yellow line markings.
 - Proposed cycle parking stand.
 - Proposed controlled crossing tactile paving.
 - Proposed uncontrolled crossing tactile paving.
 - Proposed speed hump.
 - Existing line markings to be retained.
 - Proposed tree and tree pit, subject to ground surveys.
 - Proposed planter.
 - Proposed bench.
 - Proposed collapsible bell bollard.



Project:
**Healthy Route:
Brockwell Park to Gipsy Hill**

Title:
**Proposed Layout
Sheet 2 of 5**

Date: 22/01/2020 Scale at A1:
As stated

Status: **Consultation**

Drawing No: Q7-RO-HL-GA-00-00-02 Revision: -

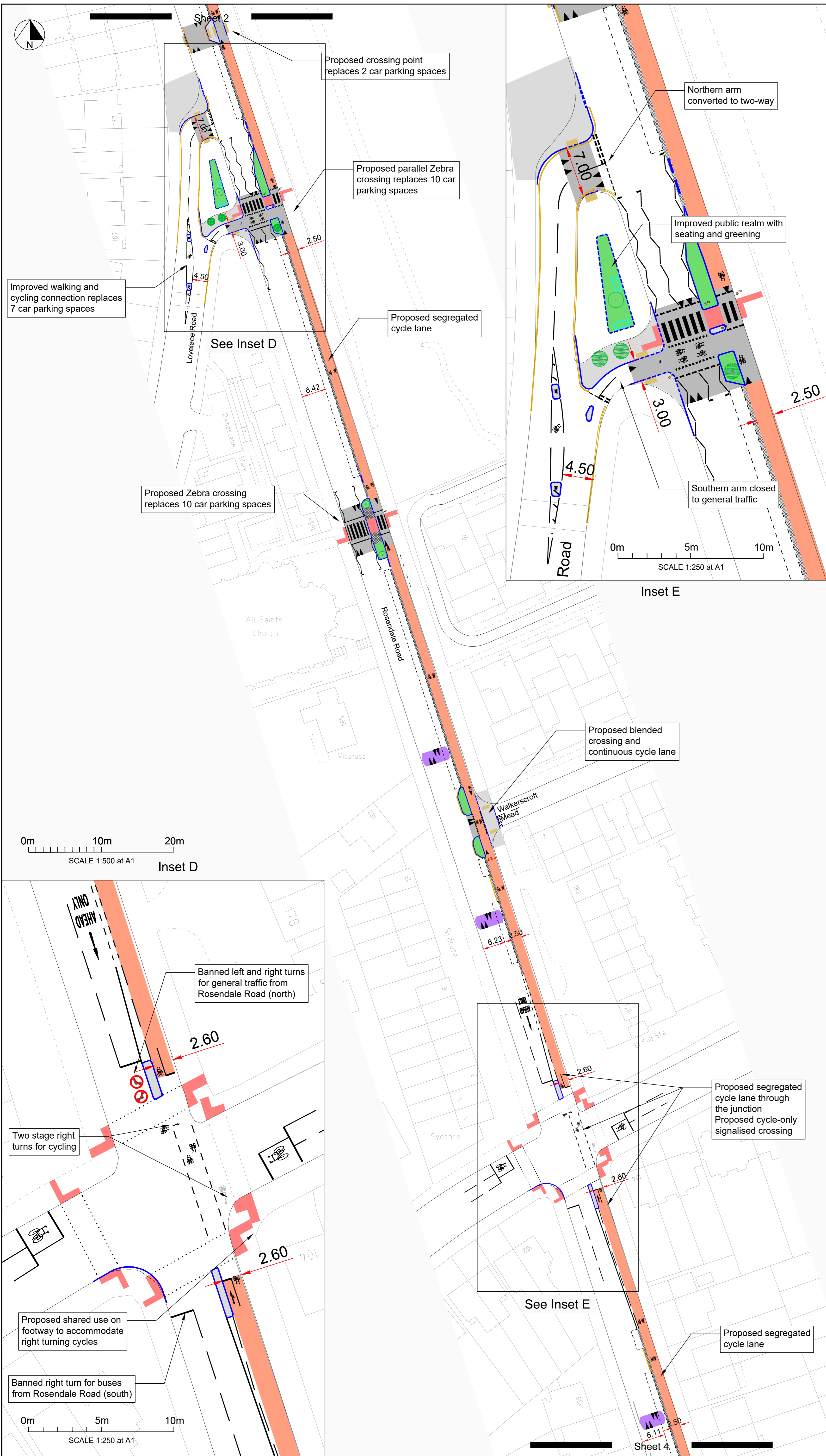

- Key:**
- Proposed greening / sustainable drainage.
 - Proposed footway paving.
 - Proposed raised table.
 - Proposed cycle track.
 - Proposed granite footway.
 - Proposed kerb.
 - Proposed dropped or flush kerb.
 - Proposed white line markings.
 - Proposed yellow line markings.
 - Proposed cycle parking stand.
 - Proposed controlled crossing tactile paving.
 - Proposed uncontrolled crossing tactile paving.
 - Proposed speed hump.
 - Existing line markings to be retained.
 - Proposed tree and tree pit, subject to ground surveys.
 - Proposed planter.
 - Proposed bench.
 - Proposed collapsible bollard.
 - Proposed collapsible bell bollard.

0m 10m 20m
SCALE 1:500 at A1
Inset D

0m 5m 10m
SCALE 1:250 at A1
Inset E

0m 5m 10m
SCALE 1:250 at A1



Project:
**Healthy Route:
Brockwell Park to Gipsy Hill**

Title:
**Proposed Layout
Sheet 3 of 5**

Date: 22/01/2020 Scale at A1: As stated

Status: **Consultation**

Drawing No: Q7-RO-HL-GA-00-00-03 Revision: -

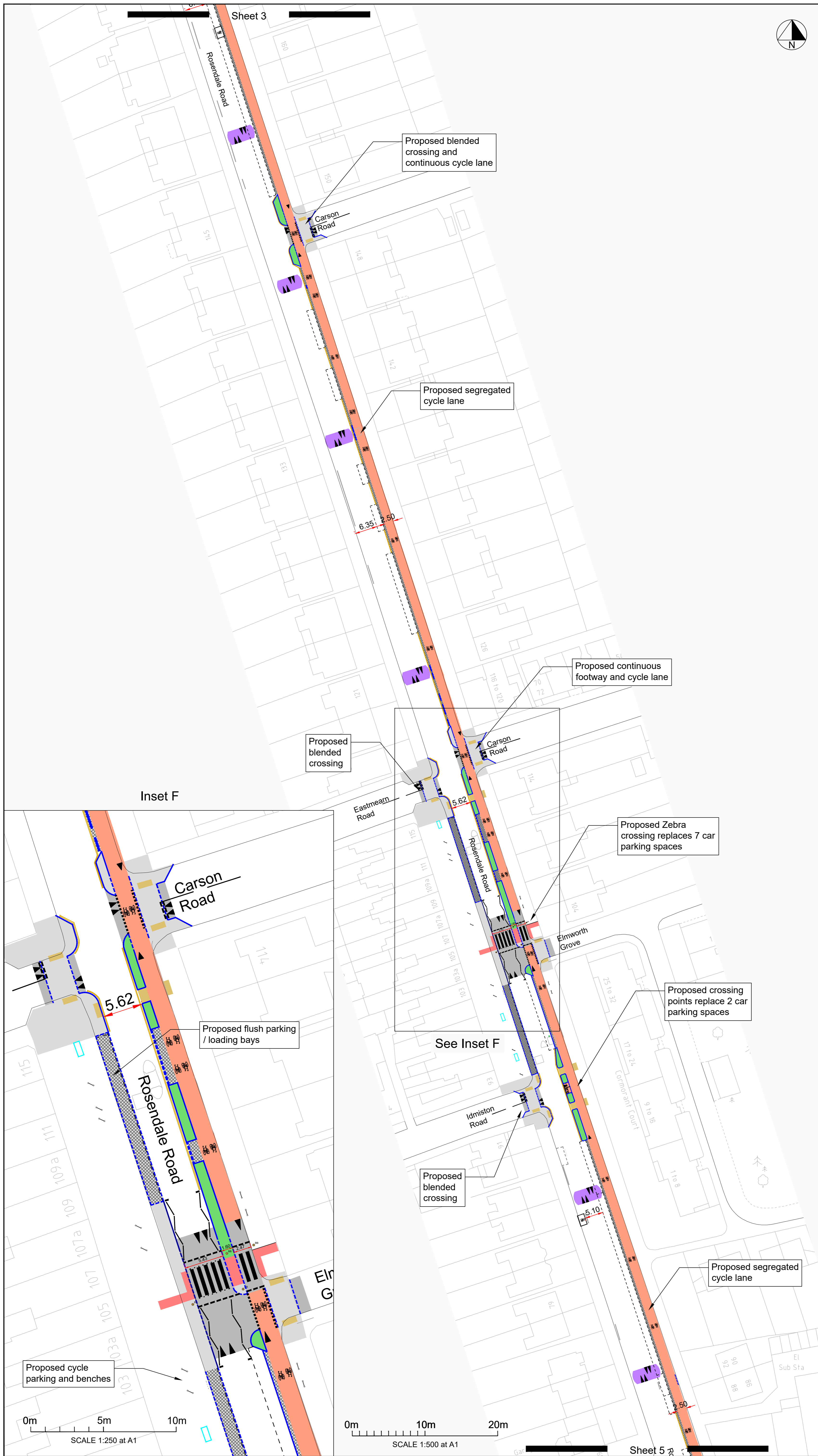

- Key:**
- Proposed greening / sustainable drainage.
 - Proposed footway paving.
 - Proposed raised table.
 - Proposed cycle track.
 - Proposed granite footway.
 - Proposed kerb.
 - Proposed dropped or flush kerb.
 - Proposed white line markings.
 - Proposed yellow line markings.
 - Proposed cycle parking stand.
 - Proposed controlled crossing tactile paving.
 - Proposed uncontrolled crossing tactile paving.
 - Proposed speed hump.
 - Existing line markings to be retained.
 - Proposed tree and tree pit, subject to ground surveys.
 - Proposed planter.
 - Proposed bench.
 - Proposed collapsible bollard.
 - Proposed collapsible bell bollard.

Inset F

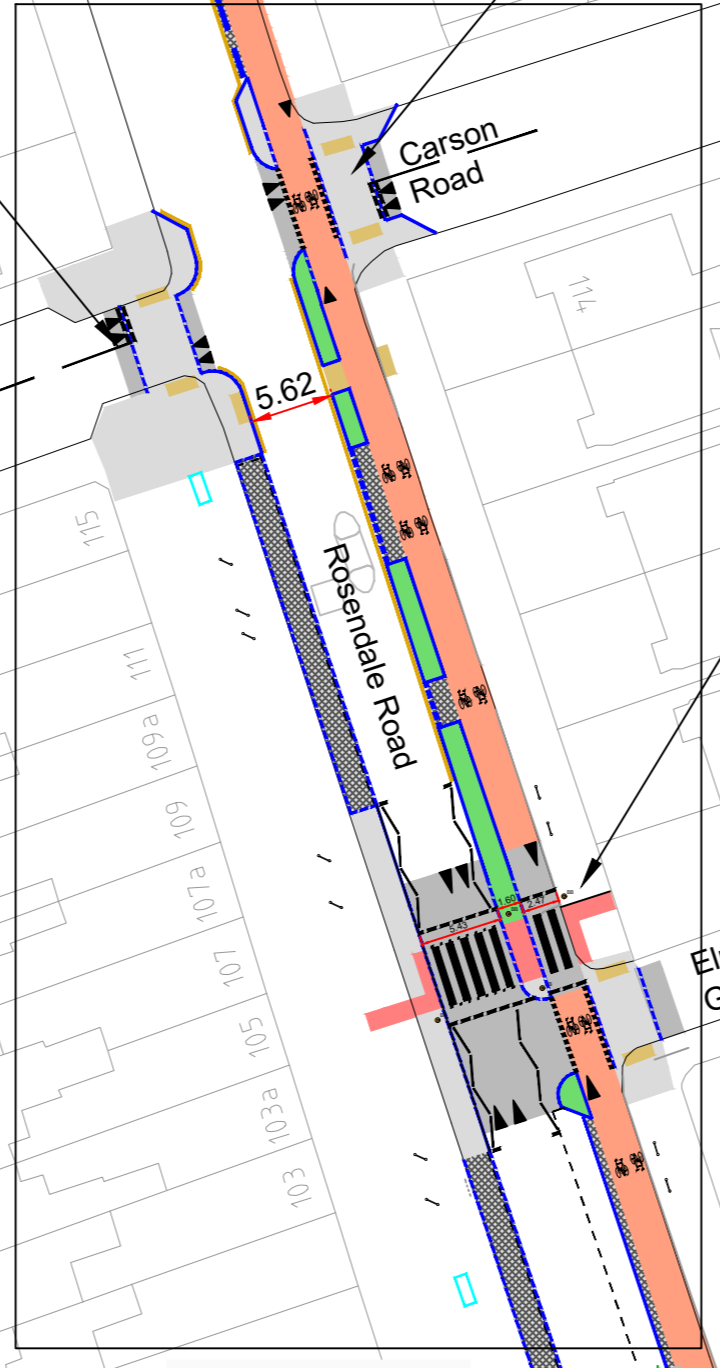
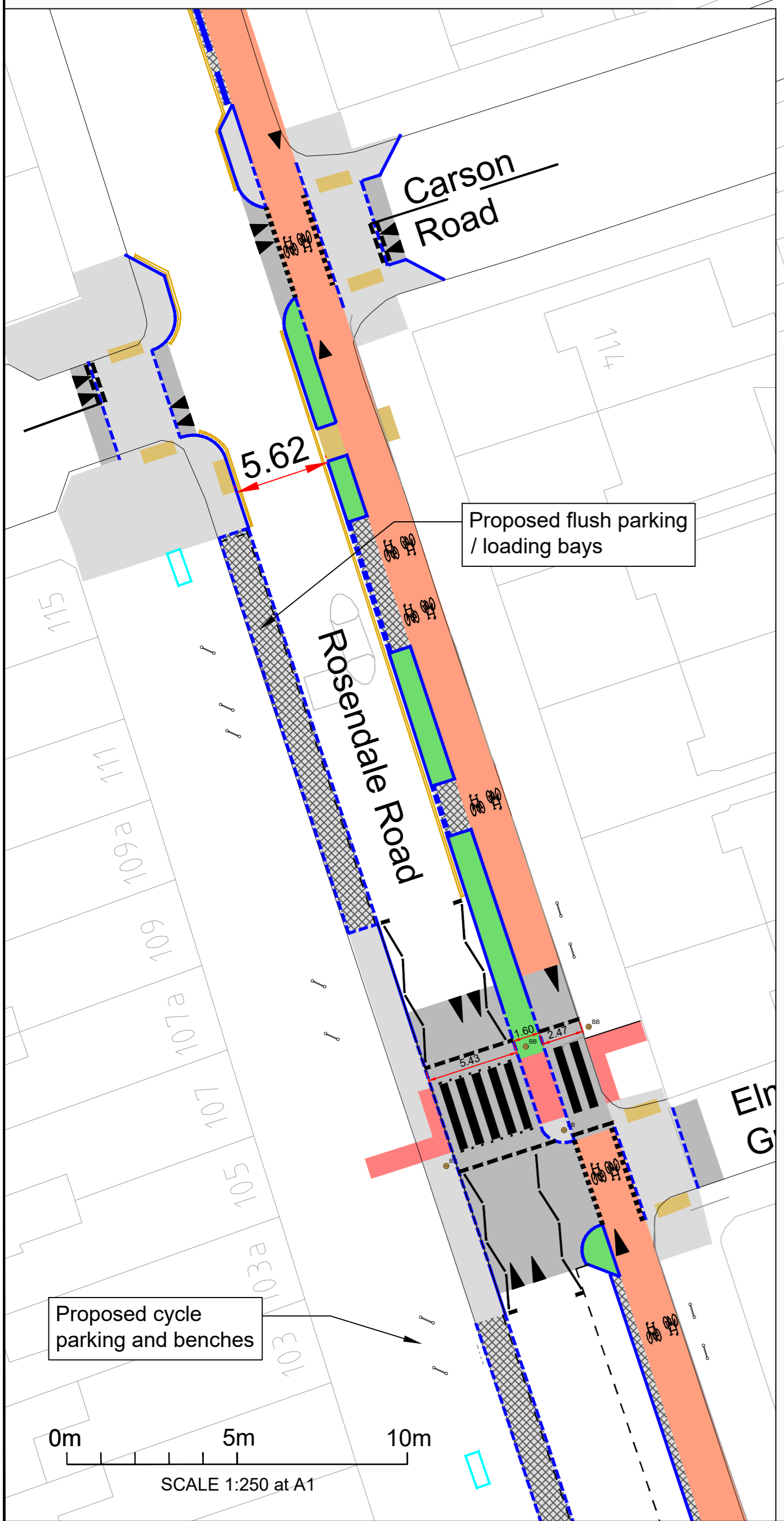

See Inset F

Project: **Healthy Route: Brockwell Park to Gipsy Hill**

Title: **Proposed Layout Sheet 4 of 5**

Date: 22/01/2020 Scale at A1: As stated

Status: **Consultation**

Drawing No: Q7-RO-HL-GA-00-00-04 Revision: -



- Key:**
- Proposed greening / sustainable drainage.
 - Proposed footway paving.
 - Proposed raised table.
 - Proposed cycle track.
 - Proposed granite footway.
 - Proposed kerb.
 - Proposed dropped or flush kerb.
 - Proposed delineation kerb.
 - Proposed white line markings.
 - Proposed yellow line markings.
 - Proposed cycle parking stand.
 - Proposed controlled crossing tactile paving.
 - Proposed uncontrolled crossing tactile paving.
 - Proposed speed hump.
 - Existing line markings to be retained.
 - Proposed tree and tree pit, subject to ground surveys.
 - Proposed planter.
 - Proposed bench.
 - Proposed collapsible bollard.
 - Proposed collapsible bell bollard.

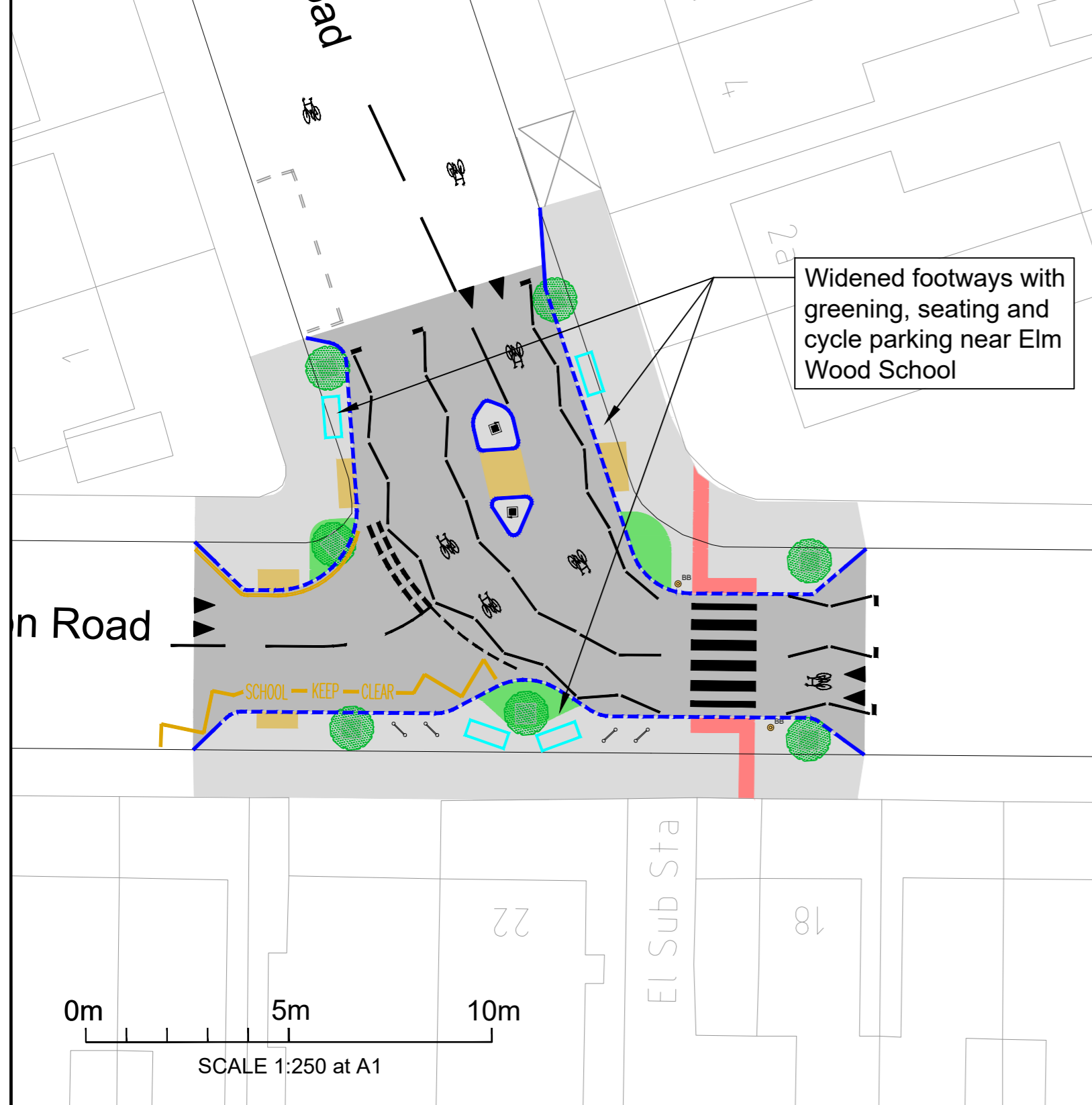
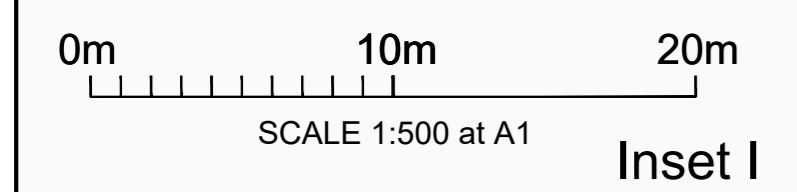
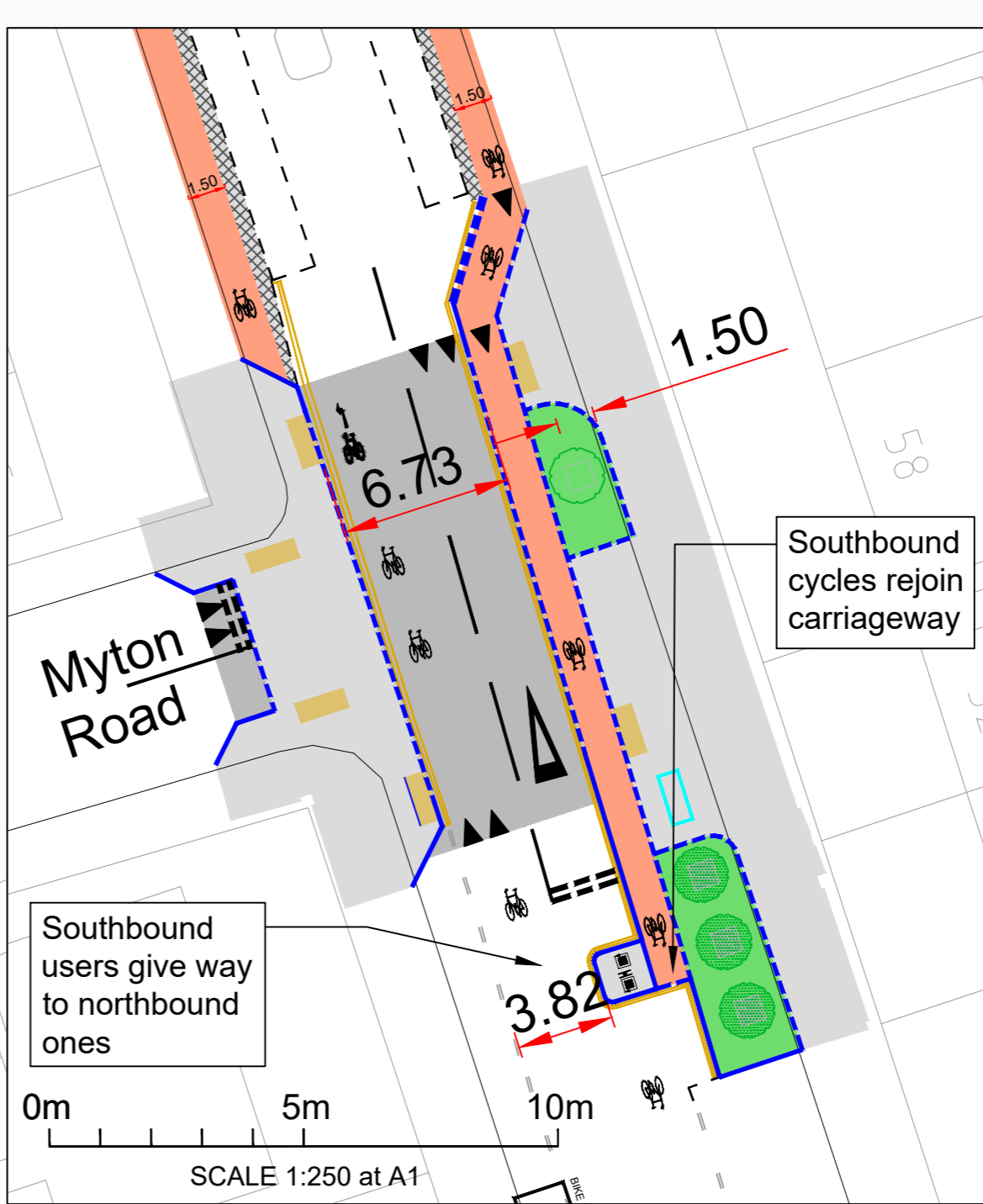
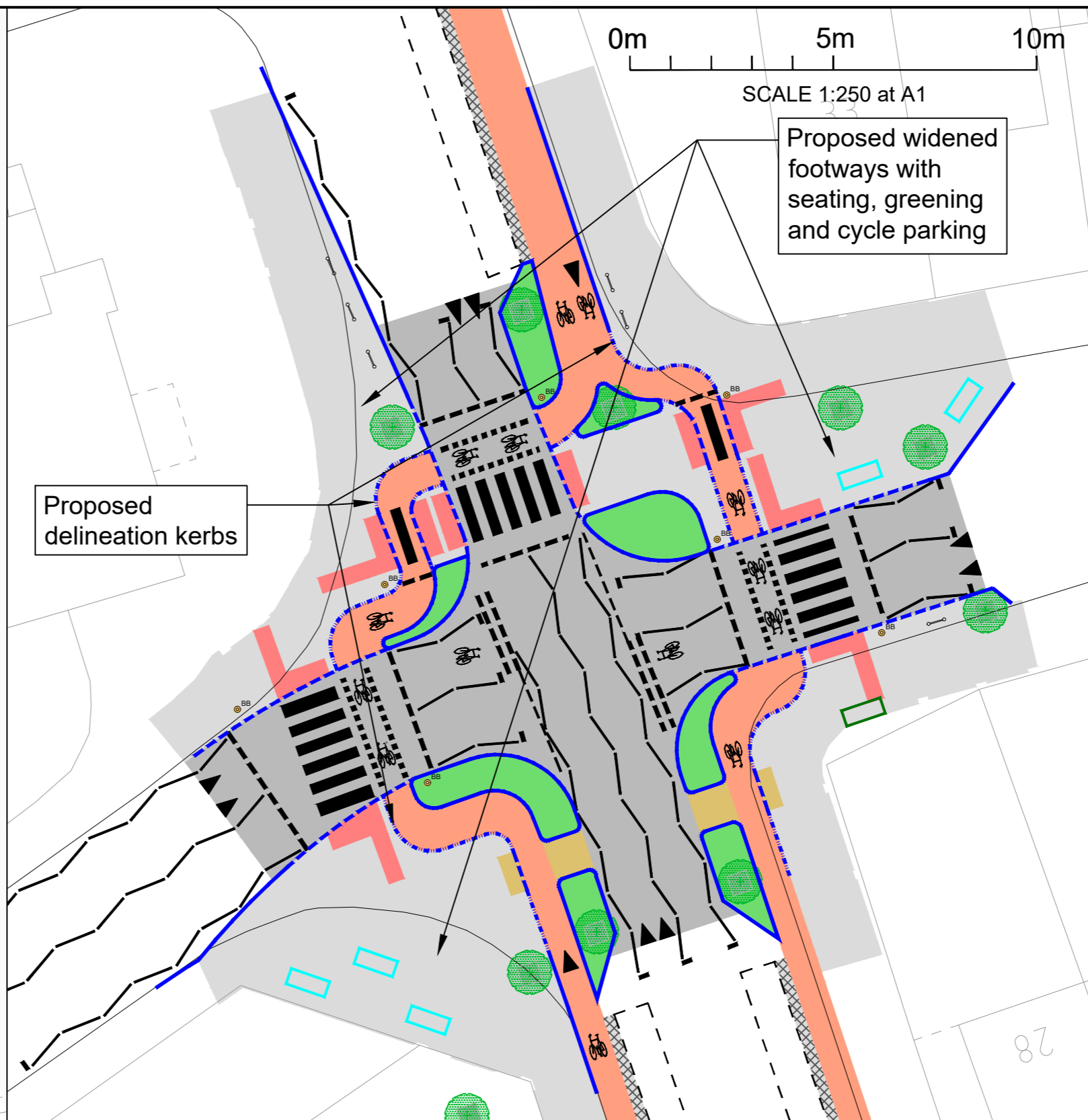



Project:
**Healthy Route:
Brockwell Park to Gipsy Hill**

Title:
**Proposed Layout
Sheet 5 of 5**

Date:
22/01/2020

Status:
Consultation

Drawing No:
Q7-RO-HL-GA-00-00-05

Scale at A1:
As stated

Revision:
-